

SYNTESI[®] ACCESSORIES

MOUNTING BRACKET FOR REG. AND FR

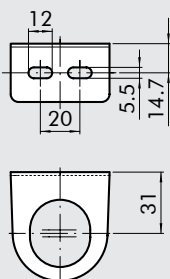

Code	Description
9200701	SF100- BIT-ND 1/4 - SY 1

PRESSURE GAUGES

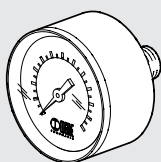

Code	Description
9700101	M 40 1/8 12
9700102	M 40 1/8 04
9800101	M 50 1/8 12
9800102	M 50 1/8 04

COIL FOR APR AND V3V SOLENOID

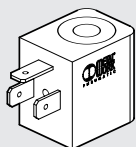

Code	Description
W0215000101	Coil 22 Ø 8 BA 2W-24VDC
W0215000111	Coil 22 Ø 8 BA 3.5VA-24VAC
W0215000121	Coil 22 Ø 8 BA 3.5VA-110VAC
W0215000131	Coil 22 Ø 8 BA 3.5VA-220VAC

KIT FOR COIL EEXM

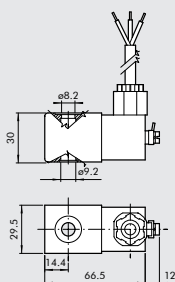

Code	Description
0227606913	Kit for coil 30 24 VDC EEXMT5 cable 3m
0227606915	Kit for coil 30 24 VDC EEXMT5 cable 5m
0227608013	Kit for coil 30 24 VAC EEXMT5 cable 3m
0227608015	Kit for coil 30 24 VAC EEXMT5 cable 5m
0227608023	Kit for coil 30 110 VAC EEXMT5 cable 3m
0227608025	Kit for coil 30 110 VAC EEXMT5 cable 5m
0227608033	Kit for coil 30 230 VAC EEXMT5 cable 3m
0227608035	Kit for coil 30 230 VAC EEXMT5 cable 5m

Bobine a normativa Atex 94/9 CE, gruppo II, categoria 2 GD

ELECTRIC CONNECTOR FOR V3V-APR ELPN

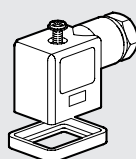

Code	Description
W0970510011	Connector standard
W0970510012	Connector 22 LED 24V
W0970510013	Connector 22 LED 110V
W0970510014	Connector 22 LED 220V
W0970510015	Connector 22 LED VDR 24V
W0970510016	Connector 22 LED VDR 110V
W0970510017	Connector 22 LED VDR 220V
W0970510070	Connector 22 standard ATEX

BOWL DISASSEMBLY SPANNER

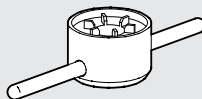

Code	Description
9170601	CS TF - TL BIT/SY 1

THREADED PORT

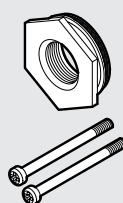

Code	Description
9210001	Kit IN OUT 1/8 SY 1
9210002	Kit IN OUT 1/4 SY 1
9210003	Kit IN OUT 3/8 SY 1

Note: no. 20 each box

Max torque 0.4 Nm

CONNECTING NIPPLE KIT

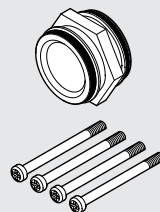

Code	Description
9210000	Connecting nipple kit SY 1

Note: no. 20 each box

Max torque 0.4 Nm

WALL-FIXING SCREW KIT

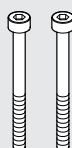

Code	Description
9210030	Kit of M4 fixing screws SY 1

Note: no. 20 screws each box

Max torque 0.8 Nm

PADLOCK

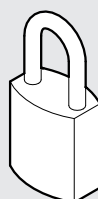

Code	Description
9062401	Padlock

REGTRONIC CONNECTING KIT

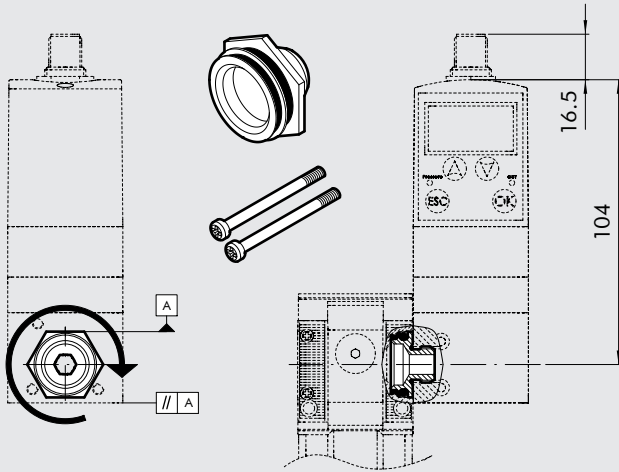

Code	Description
9210004	Adaptor for REGTRONIC 1/4 SY 1

Max torque for screw, 0.4 Nm

Instructions:

- 1) Screw the connecting bushing onto the REGTRONIC 1/4 as far as it will go. Use sealant on the G1/4 thread to provide a further seal.
- 2) Unscrew the bushing slightly until two surfaces of the hexagon are parallel to the body of REGTRONIC 1/4 (see diagram).
- 3) Insert the bushing into the Syntesi® unit.
- 4) Tighten the two self-tapping screws in the Syntesi® unit to a torque of 0.4 Nm max.

NOTES

AUTOMATIC DRAIN COCK (RA)

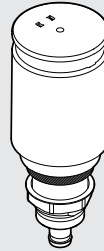

Code	Description
9000802	RA automatic drain spare part

CUP RMSA/RA

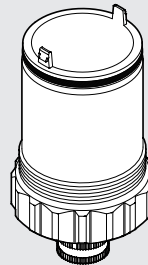

Code	Description
9210100	Cup FIL FR DEP RMSA SY 1
9210101	Cup FIL FR RA SY 1

LUBRICATOR CUP

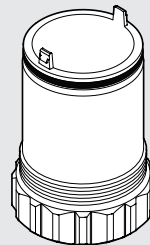

Code	Description
9210110	Cup LUB SY 1

FILTERING ELEMENT

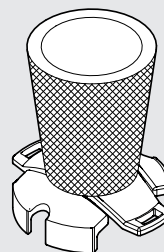

Code	Description
9210150	Filtering element 5 µm SY 1
9210151	Filtering element 20 µm SY 1
9210152	Filtering element 50 µm SY 1

PURIFIER FILTERING ELEMENT



Code	Description
9210160	Cartridge DEP SY 1

AC FILTERING ELEMENT

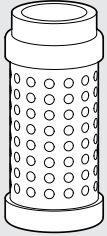

Code	Description
9210161	Cartridge AC SY 1

TRANSPARENT LUBRICATOR COVER

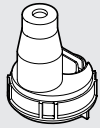

Code	Description
9210180	Transparent cover LUB SY 1

LUBRICATOR OIL-FILLING CAP

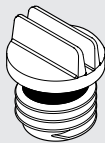

Code	Description
9210181	Oil-filling cap LUB SY 1

SPRINGS FOR REGULATORS AND FR

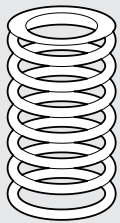

Code	Description
9210190	MO 02 SY 1
9210191	MO 04 SY 1
9210192	MO 08 SY 1
9210193	MO 012 SY 1

BELL FOR REG AND FR

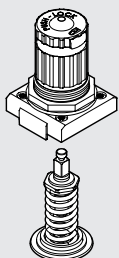

Code	Description
9210200	Bell 02 SY 1
9210201	Bell 04 SY 1
9210202	Bell 08 SY 1
9210203	Bell 012 SY 1

POPPET FOR REG

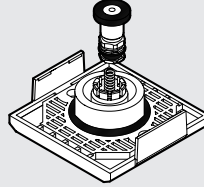

Code	Description
9210210	Poppet REG SY 1

POPPET FOR FR

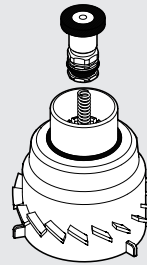

Code	Description
9210211	Poppet FR 5 µm SY 1
9210212	Poppet FR 20 µm SY 1
9210213	Poppet FR 50 µm SY 1

NOTES